

# FIVE STAR

P R O P E R T Y



## The Garbo, 35 Jenkins Avenue, Retford, DN22 6HA

AN ATTRACTIVE 3 BEDROOM SEMI DETACHED HOME WITH FEATURE BAY - HIGH QUALITY FINISH THROUGHOUT - OPEN PLAN LIVING/DINING/KITCHEN - UTILITY 3 BEDROOMS - 2 BATHROOMS - GARAGE - PARKING - GARDEN - CALL FOR FURTHER DETAILS 01777 708700.

- Semi Detached House
- 3 Bedrooms & 2 Bathrooms
- Open Plan Living
- Garage & Driveway
- High Quality Specification
- EPC Rating: TBC

**£329,500**

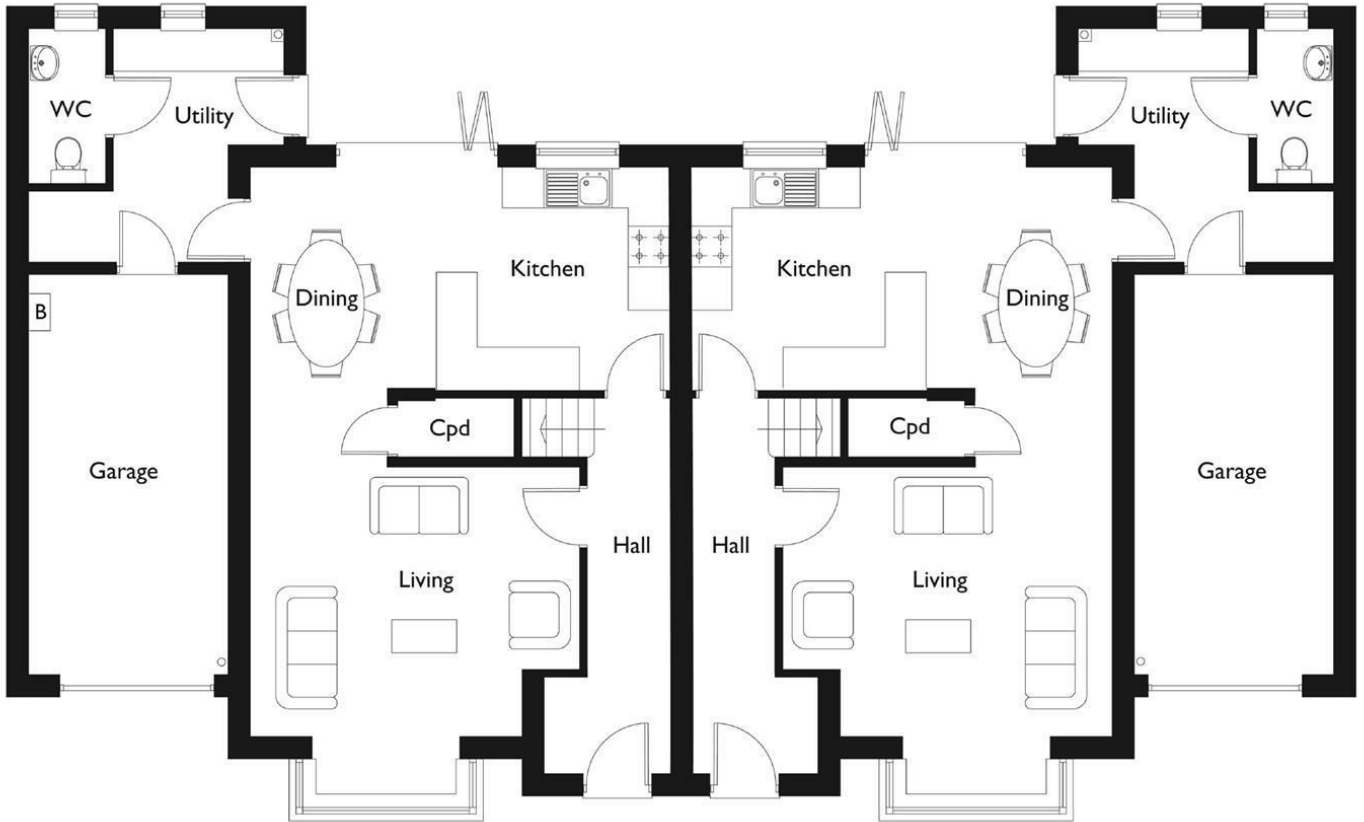

| Energy Efficiency Rating                    |                         | Current | Potential |
|---|-------------------------|---------|-----------|
| Very energy efficient - lower running costs |                         |         |           |
| (92 plus) <b>A</b>                          |                         |         |           |
| (81-91) <b>B</b>                            |                         |         |           |
| (69-80) <b>C</b>                            |                         |         |           |
| (55-68) <b>D</b>                            |                         |         |           |
| (39-54) <b>E</b>                            |                         |         |           |
| (21-38) <b>F</b>                            |                         |         |           |
| (1-20) <b>G</b>                             |                         |         |           |
| Not energy efficient - higher running costs |                         |         |           |
| <b>England &amp; Wales</b>                  | EU Directive 2002/91/EC |         |           |

| Environmental Impact (CO <sub>2</sub> ) Rating                  |                         | Current | Potential |
|---|-------------------------|---------|-----------|
| Very environmentally friendly - lower CO <sub>2</sub> emissions |                         |         |           |
| (92 plus) <b>A</b>  |                         |         |           |
| (81-91) <b>B</b>  |                         |         |           |
| (69-80) <b>C</b>  |                         |         |           |
| (55-68) <b>D</b>  |                         |         |           |
| (39-54) <b>E</b>  |                         |         |           |
| (21-38) <b>F</b>  |                         |         |           |
| (1-20) <b>G</b>   |                         |         |           |
| Not environmentally friendly - higher CO <sub>2</sub> emissions |                         |         |           |
| <b>England &amp; Wales</b>                                      | EU Directive 2002/91/EC |         |           |